

**NOKIA**

# **Nokia 225 4G (2024)**

## **User Guide**

# Table of Contents

<b>1</b>	<b>About this user guide</b>	<b>4</b>
<b>2</b>	<b>Get started</b>	<b>5</b>
	Keys and parts . . . . .	5
	Set up and switch on your phone . . . . .	6
	Charge your device . . . . .	8
	Keypad . . . . .	9
<b>3</b>	<b>☎, 📧, 📧 📧 📧</b>	<b>11</b>
	Calls . . . . .	11
	Contacts . . . . .	11
	Send messages . . . . .	12
<b>4</b>	<b>🔊 📱 📱 📱 📱 📱</b>	<b>13</b>
	Change tones . . . . .	13
	Change the look of your home screen . . . . .	13
	Profiles . . . . .	13
	Battery life . . . . .	13
	Accessibility . . . . .	14
	Repairability . . . . .	15
<b>5</b>	<b>📷</b>	<b>16</b>
	Photos and videos . . . . .	16
<b>6</b>	<b>🕒, 🕒 🕒 🕒 🕒 🕒</b>	<b>17</b>
	Set the time and date manually . . . . .	17
	Alarm clock . . . . .	17
	Calendar . . . . .	17
	Calculator . . . . .	17
<b>7</b>	<b>🗑️</b>	<b>18</b>
	Restore factory settings . . . . .	18

<b>8 Product and safety information</b>	<b>19</b>
For your safety . . . . .	19
□□□□□ □□ . . . . .	21
□□□□□ □□□□□□□□□□ □□□□ □□□□ . . . . .	22
□□□□□□□□□□ □□□□□ . . . . .	23
□□□□□ □□□□□□ □□□□□ □□□□□□□□□□ □□□□□□□□□□ . . . . .	23
<b>Battery and charger information</b> . . . . .	<b>23</b>
□□□□ □□□□□□□□ . . . . .	25
□□□□□□□□□□ □□□□□□□□□□□ . . . . .	25
□□□□□□□□□□ □□□□□□□□□□□□ □□□□□□□□□□□□□□□□ . . . . .	25
□□□□□□ □□□□□□□□ . . . . .	25
<b>Protect your device from harmful content</b> . . . . .	<b>25</b>
□□□□□□□□ □□□□□□ . . . . .	26
□□□□□□□□□□ □□□□□□□□□□□□□□□□ □□□□□□□□ . . . . .	26
□□□□□□□□□□□□□□ □□□□□ (SAR) . . . . .	26
□□□□□□□□ □□□□□□□□ □□□□□□□□□□□□ □□□□□□□□□□□□ . . . . .	27
<b>Copyrights and other notices</b> . . . . .	<b>27</b>

# 1 About this user guide



**Important:** For important information on the safe use of your device and battery, read “Product and safety information” before you take the device into use. To find out how to get started with your new device, read the user guide.

## 2 Get started

### KEYS AND PARTS

#### Your phone

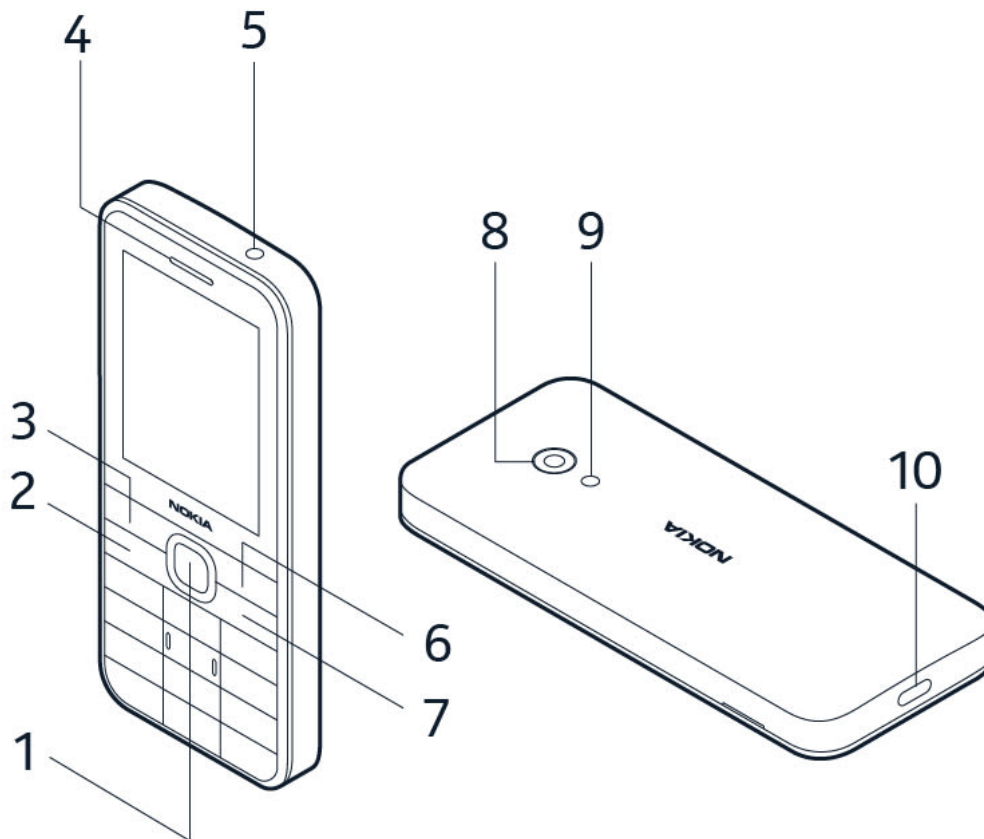

This user guide applies to the following models: TA-1610, TA-1625, TA-1689.

- |                         |                        |
|-------------------------|------------------------|
| 1. Scroll key           | 6. Right selection key |
| 2. Call key             | 7. Power/End key       |
| 3. Left selection key   | 8. Camera              |
| 4. Earpiece/Loudspeaker | 9. Flashlight          |
| 5. Headset connector    | 10. USB connector      |

Some of the accessories mentioned in this user guide, such as charger, headset, or data cable, may be sold separately.



**Note:** You can set the phone to ask for a security code. Select **Menu** > **Settings** > **Security** > **Keyguard** > **Security code**, and enter a code. Note, however, that you need to remember the code, as HMD Global is not able to open or bypass it.



## Open the back cover

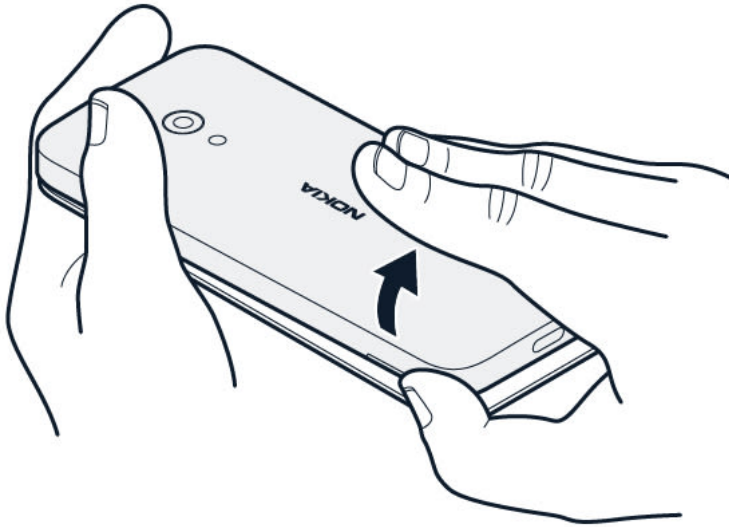

1. Put your fingernail in the small slot at the side of the phone, lift and remove the cover.
2. If the battery is in the phone, lift it out.

## Insert the SIM cards

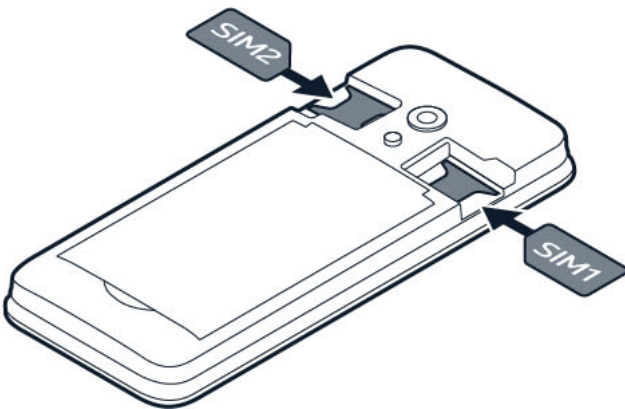

1. Slide the SIM card in the SIM card slot.
2. If you have a dual-SIM phone, slide the second SIM in the SIM2 slot.

Both SIM cards are available at the same time when the device is not being used, but while one SIM card is active, for example, making a call, the other may be unavailable.



**Tip:** To find out if your phone can use 2 SIM cards, see the label on the sales box. If there are 2 IMEI codes on the label, you have a dual-SIM phone.

## Insert the memory card

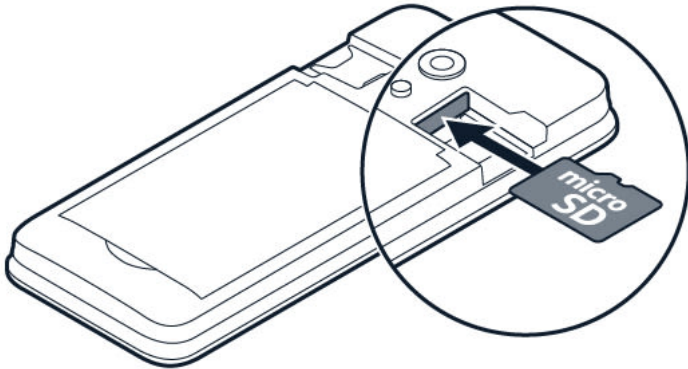

1. Slide the memory card in the memory card slot.
2. Put back the battery.
3. Put back the back cover.

Use only compatible memory cards approved for use with this device. Incompatible cards may damage the card and the device and corrupt data stored on the card.



**Tip:** Use a fast, up to 32 GB microSD memory card from a well-known manufacturer.

□□□□□ □□ □□□□□

Ⓢ □□ □□□□ □□ □□□□□□

## CHARGE YOUR DEVICE

Your battery has been partially charged at the factory, but you may need to recharge it before you can use your device.

### Charge the battery

1. Plug the charger into a wall outlet.
2. Connect the charger to the device.

Do not overcharge the battery: once charging of your device is complete, first unplug the charger from the device and then from the electrical outlet.

Do not overuse the battery: avoid letting the battery charge drop below 20% or using it until it runs out of power and shuts down.

If the battery is completely discharged, it may take several minutes before the charging indicator is displayed.



**Tip:** You can use USB charging when a wall outlet is not available. The efficiency of USB charging power varies significantly, and it may take a long time for charging to start and the device to start functioning.

### Charger model

**For EU countries:** Use your device only with an original BL-25AA rechargeable battery. Charge your device with the HAC-18 charger. Charger plug type may vary. HMD Global may make additional battery or charger models available for this device.

For environmental reasons this package does not include a charger. This device can be powered with most USB power adapters and a cable with USB Type-C plug. Use only chargers and cables that are compliant with applicable country regulations, and international and regional safety standards to avoid any risk of property loss or personal injury. The power delivered by the charger must be between min 2 Watts required by the radio equipment, and max 5 Watts in order to achieve the maximum charging speed.

Your device supports the USB-C cable. You can also charge your device from a computer with a USB cable, but it may take a longer time.

**For other countries:** Charge your device with the HAD-005 charger. HMD Global may make additional battery or charger models available for this device. Charging time can vary depending on device capability. Some of the accessories mentioned in this user guide, such as charger, headset, or data cable, may be sold separately.

When charger is not included in the sales box, charge your device using the data cable (included) and a USB power adaptor (may be sold separately). You can charge your device with third-party cables and power adaptors that are compliant with USB 2.0 or later and with applicable country regulations and international and regional safety standards. Other adaptors may not meet applicable safety standards, and charging with such adaptors could pose a risk of property loss or personal injury. It is recommended to use a power adaptor with an input of 100-240V~50/60Hz 0.1A and output of 5V/1A to optimise the charging of your device.

## KEYPAD

### Use the phone keys

- To see the apps and features of your phone, on the home screen, select **Menu**.
- To go to an app or feature, press the scroll key up, down, left, or right. To open the app or feature, press the scroll key.

- If you have selected the zoomed menu view, press the scroll key up or down to go to an app or feature. To open the app or feature, press the scroll key.

### Lock the keypad

To lock the keys, select  > **Lock keypad**. To unlock the keys, select **Unlock**, and press \*.

### Write with the keypad

Press a key repeatedly until the letter is shown.

To type in a space press **0**.

To type in a special character or punctuation mark, press the asterisk key, or if you are using predictive text, press and hold the # key.

To switch between character cases, press **#** repeatedly.

To type in a number, press and hold a number key.

### 3 𐀀, 𐀀𐀀𐀀𐀀𐀀𐀀 𐀀𐀀 𐀀𐀀𐀀𐀀𐀀

## CALLS

𐀀𐀀 𐀀𐀀

𐀀𐀀𐀀𐀀𐀀 𐀀𐀀𐀀𐀀 𐀀𐀀𐀀 𐀀𐀀 𐀀𐀀𐀀 𐀀𐀀 𐀀𐀀𐀀𐀀 𐀀𐀀 𐀀𐀀𐀀𐀀𐀀!

1. 𐀀𐀀 𐀀𐀀𐀀𐀀 𐀀𐀀𐀀 𐀀𐀀𐀀𐀀 𐀀𐀀𐀀𐀀𐀀𐀀𐀀𐀀𐀀 𐀀𐀀𐀀 𐀀𐀀𐀀 𐀀𐀀𐀀𐀀𐀀𐀀 + 𐀀𐀀𐀀𐀀 𐀀𐀀𐀀 𐀀𐀀𐀀 𐀀𐀀𐀀 \* 𐀀𐀀'𐀀𐀀𐀀 𐀀𐀀𐀀𐀀!
2. 𐀀𐀀𐀀𐀀𐀀! 𐀀𐀀𐀀𐀀𐀀𐀀𐀀 𐀀𐀀 𐀀𐀀 𐀀𐀀 𐀀𐀀 𐀀𐀀𐀀𐀀𐀀𐀀 𐀀𐀀𐀀 𐀀𐀀 𐀀𐀀 𐀀𐀀𐀀𐀀𐀀
3. 𐀀𐀀 𐀀𐀀 𐀀𐀀𐀀, 𐀀𐀀𐀀 𐀀𐀀𐀀𐀀𐀀

𐀀𐀀𐀀𐀀 𐀀𐀀𐀀𐀀 𐀀𐀀𐀀𐀀𐀀 𐀀𐀀

𐀀𐀀𐀀𐀀𐀀!

## CONTACTS

### Add a contact

1. Select **Menu** > **Contacts** > **≡** > **Add new contact**.
2. Select where to save the contact.
3. Write the name, and type in the number.
4. Select **≡** > **Save contact**.

### Save a contact from the call logs

1. Select **Menu** > **Call logs**, and select the call type.
2. Scroll to the number you want to save and select **≡** > **Add to contacts** > **New contact**.
3. Select where to save the contact.
4. Add the contact details and select **≡** > **Save contact**.

### Call a contact

You can call a contact directly from the contacts list.

Select **Menu** > **Contacts**, scroll to the contact you want to call, and press the call key.

## SEND MESSAGES

### Write and send messages

1. Select **Menu** > **Messages** > **+ New message**.
2. Type in a phone number, or press  and select a recipient from your contacts list.
3. Write your message.
4. To insert symbols to the message, press \*.
5. Select **Send**. If asked, select which SIM to use.

## 4 音調を変更する

### CHANGE TONES

#### Set new tones

1. Select **Menu** > **Settings** > **Profiles**, scroll to a profile and select ≡ > **Settings** > **Ring settings**.
2. Select which tone you want to change.
3. Scroll to the tone that you want and select **Select**.

### CHANGE THE LOOK OF YOUR HOME SCREEN

#### Choose a new wallpaper

You can change the background of your home screen.

1. Select **Menu** > **Settings** > **Personalisation** > **Lock screen background** > **Wallpapers**.
2. Select the wallpaper you want.

### PROFILES

#### Set a profile

There are several profiles that you can use in different situations. There is, for example, a silent profile for when you cannot have sounds on, and an outdoor profile with loud tones.

1. Select **Menu** > **Settings** > **Profiles**.
2. To adjust a profile, scroll to it, and select ≡ > **Settings**. Change the settings you want.
3. To set on a profile, scroll to it, and select **Select**.

### BATTERY LIFE

#### Save power

If applicable:

- Use network connections selectively for power saving: Switch Bluetooth on only when needed.
- Use a Wi-Fi connection to connect to the internet, rather than a mobile data connection.
- If you don't want to make or receive calls, switch the airplane mode on.

Airplane mode closes connections to the mobile network and switches your device's wireless features off.

## ACCESSIBILITY

### Make the text bigger

You can adjust the text size to be smaller or larger.

Depending on your device model, go to the system or display settings to adjust.

### Learn more about accessibility features

To learn more about this device's accessibility features, please visit the Global Accessibility Reporting Initiative: <https://www.gari.info/findphones.cfm>

### Note for audio online guide

1. To access the online user guide, please visit [www.hmd.com/support](http://www.hmd.com/support). Find your product model and access the relevant online user guide.
2. Enable the text-to-speech feature on your browser or device to have on-screen text read aloud.

### How to activate the text-to-speech feature

#### Windows PCs (Windows 10, 11, or newer):

- Go to Settings > Ease of Access (Windows 10) or Accessibility (Windows 11).
- Select Narrator and toggle it on to activate the built-in screen reader.

#### On earlier Windows versions:

- Install a browser extension like Speechify to read web content aloud.

#### Mac®/macOS®:

- In Safari, go to Edit > Speech > Start Speaking to have your Mac read the text aloud.
- To stop, go to Edit > Speech > Stop Speaking.

For detailed instructions on enabling text-to-speech for your device or browser, please refer to your device's user guide.

## REPAIRABILITY

### Self-repair options

Self-repair support is available for certain devices in select countries. Details are available at [www.hmd.com/self-repair](http://www.hmd.com/self-repair).

## 5 Camera



### PHOTOS AND VIDEOS

#### Take a photo

1. Select **Menu** > **Camera**.
2. To zoom in or out, scroll up or down.
3. To take a photo, press the scroll key.

To see the photo you just took, on the home screen, select **Menu** > **Gallery**.

#### Record a video

1. To switch the video camera on, select **Menu** > **Camera** and scroll to .
2. To start recording, press the scroll key.
3. To stop recording, select .

To see the video you just recorded, on the home screen, select **Menu** > **Videos**.

## 6 時間, 日付, 時刻表, 時計, 日付, 時刻表

### SET THE TIME AND DATE MANUALLY

#### Change the time and date

1. Select **Menu** > **Settings** > **Time & language** > **Date and time** .
2. Select **Auto-update** > **Change** .
3. Select **Time zone** and enter the time zone.
4. Select **Time** and enter the time.
5. Select **Date** and enter the date.
6. Select **Save** .

### ALARM CLOCK

#### Set an alarm

1. Select **Menu** > **Alarm** .
2. Select **New alarm** and enter the alarm time and other details.

### CALENDAR

#### Add a calendar event

1. Select **Menu** > **Extras** > **Calendar** .
2. Scroll to a date, and select **≡** > **Add new event** .
3. Enter the event name and other details, and select **Save** .

### CALCULATOR

#### Use the calculator

1. Select **Menu** > **Extras** > **Calculator** .
2. Enter the first factor of your calculation, use the scroll key to select the operation, and enter the second factor.
3. Press the scroll key to get the result of the calculation.

Select **☒** to empty the number fields.

## 7 Empty your phone

### RESTORE FACTORY SETTINGS

Restoring factory settings

Restoring factory settings will erase all data on your phone, including contacts, messages, photos, videos, and apps. You will need to set up your phone again and restore your data from a backup. If you have a backup, you can restore it after restoring factory settings. If you do not have a backup, you will lose all data on your phone.

Before restoring factory settings, you should back up your data. You can use the Nokia Backup app to create a backup of your data. You can also use a computer to back up your data. For more information, see the Nokia Backup app or the Nokia website.

After restoring factory settings, you will need to set up your phone again. You can use the Nokia Backup app to restore your data from a backup. You can also use a computer to restore your data. For more information, see the Nokia Backup app or the Nokia website.

1. **Settings** >  > **System > Factory reset** to restore factory settings.
2. After restoring factory settings, you will need to set up your phone. **Settings** > **System > Factory reset** to restore factory settings.





## GLASS PARTS



The device and/or its screen is made of glass. This glass can break if the device is dropped on a hard surface or receives a substantial impact. Stop using the device until the glass is replaced.

பிழிந்த கண்ணாடி பகுதிகளை கவனமாக கையாளுங்கள்.



பிழிந்த கண்ணாடி பகுதிகளை கவனமாக கையாளுங்கள், கண்ணாடி பகுதிகள் உங்களுக்கு அல்லது உங்கள் குழந்தைகளுக்கு காயம் ஏற்படுத்தும் வகையில் இருக்கலாம். கண்ணாடி பகுதிகளை கவனமாக கையாளுங்கள்.

பிழிந்த கண்ணாடி



பிழிந்த கண்ணாடி பகுதிகளை கவனமாக கையாளுங்கள். கண்ணாடி பகுதிகள் உங்களுக்கு அல்லது உங்கள் குழந்தைகளுக்கு காயம் ஏற்படுத்தும் வகையில் இருக்கலாம். கண்ணாடி பகுதிகளை கவனமாக கையாளுங்கள்.

பிழிந்த கண்ணாடி:

- கண்ணாடி பகுதிகளை கவனமாக கையாளுங்கள்.
- கண்ணாடி பகுதிகளை கவனமாக கையாளுங்கள். கண்ணாடி பகுதிகள் உங்களுக்கு அல்லது உங்கள் குழந்தைகளுக்கு காயம் ஏற்படுத்தும் வகையில் இருக்கலாம்.
- கண்ணாடி பகுதிகளை கவனமாக கையாளுங்கள். கண்ணாடி பகுதிகள் உங்களுக்கு அல்லது உங்கள் குழந்தைகளுக்கு காயம் ஏற்படுத்தும் வகையில் இருக்கலாம்.

1. கண்ணாடி பகுதிகளை கவனமாக கையாளுங்கள். கண்ணாடி பகுதிகள் உங்களுக்கு அல்லது உங்கள் குழந்தைகளுக்கு காயம் ஏற்படுத்தும் வகையில் இருக்கலாம்.
2. கண்ணாடி பகுதிகளை கவனமாக கையாளுங்கள். கண்ணாடி பகுதிகள் உங்களுக்கு அல்லது உங்கள் குழந்தைகளுக்கு காயம் ஏற்படுத்தும் வகையில் இருக்கலாம். கண்ணாடி பகுதிகளை கவனமாக கையாளுங்கள்.
3. கண்ணாடி பகுதிகளை கவனமாக கையாளுங்கள்.



Recycling symbol



This symbol indicates that the device is made of recyclable materials. It should be disposed of in a designated recycling bin. Do not dispose of the device in a regular trash bin. For more information on recycling, see the printed guide.

Do not dispose of the device in a regular trash bin.

### Crossed-out wheeled bin symbol



This symbol indicates that the device should not be disposed of in a regular trash bin. It should be disposed of in a designated recycling bin. Do not dispose of the device in a regular trash bin. For more information on recycling, see the printed guide.

## BATTERY AND CHARGER INFORMATION

### Battery and charger info

To check if your device has a removable, non-removable, or user-replaceable battery, see the printed guide.

**Devices with a removable battery** Use your device only with an original rechargeable battery. The battery can be charged and discharged hundreds of times, but it will eventually wear out. When the talk and standby times are noticeably shorter than normal, replace the battery.

**Devices with a non-removable battery** Do not attempt to remove the battery, as you may damage the device. The battery can be charged and discharged hundreds of times, but it will eventually wear out. When the talk and standby times are noticeably shorter than normal, to replace the battery, take the device to the nearest authorized service facility.

**Devices with a user-replaceable battery** To replace the battery, follow HMD's self-repair instructions or take the device to the nearest authorized service facility. For more information about self-repair, visit [www.hmd.com/self-repair](http://www.hmd.com/self-repair).

Charge your device with a compatible charger. Charger plug type may vary. Charging time can vary depending on device capability.

### **Battery and charger safety info**

Once charging of your device is complete, unplug the charger from the device and electrical outlet. Please note that continuous charging should not exceed 12 hours. If left unused, a fully charged battery will lose its charge over time.

Extreme temperatures reduce the capacity and lifetime of the battery. Always keep the battery between 15°C and 25°C (59°F and 77°F) for optimal performance. A device with a hot or cold battery may not work temporarily. Note that the battery may drain quickly in cold temperatures and lose enough power to switch off the device within minutes. When you are outdoors in cold temperatures, keep your device warm.

Obey local regulations. Recycle when possible. Do not dispose as household waste.

Do not expose the battery to extremely low air pressure or leave it to extremely high temperature, for example dispose it in a fire, as that may cause the battery to explode or leak flammable liquid or gas.

Do not dismantle, cut, crush, bend, puncture, or otherwise damage the battery in any way. If a battery leaks, do not let liquid touch skin or eyes. If this happens, immediately flush the affected areas with water, or seek medical help. Do not modify, attempt to insert foreign objects into the battery, or immerse or expose it to water or other liquids. Batteries may explode if damaged.

Use the battery and charger for their intended purposes only. Improper use, or use of unapproved or incompatible batteries or chargers may present a risk of fire, explosion, or other hazard, and may invalidate any approval or warranty. If you believe the battery or charger is damaged, take it to a service centre or your phone dealer before continuing to use it. Never use a damaged battery or charger. Only use the charger indoors. Do not charge your device during a lightning storm.

To unplug a charger or an accessory, hold and pull the plug, not the cord.

Additionally, the following applies if your device has a removable or user-replaceable battery:

- Always switch the device off and unplug the charger before removing any covers or the battery.
- Accidental short-circuiting can happen when a metallic object touches the metal strips on the battery. This may damage the battery or the other object.







accuracy, reliability or contents of this document. HMD Global reserves the right to revise this document or withdraw it at any time without prior notice.

To the maximum extent permitted by applicable law, under no circumstances shall HMD Global or any of its licensors be responsible for any loss of data or income or any special, incidental, consequential or indirect damages howsoever caused.

Reproduction, transfer or distribution of part or all of the contents in this document in any form without the prior written permission of HMD Global is prohibited. HMD Global operates a policy of continuous development. HMD Global reserves the right to make changes and improvements to any of the products described in this document without prior notice.

HMD Global does not make any representations, provide a warranty, or take any responsibility for the functionality, content, or end-user support of third-party apps provided with your device. By using an app, you acknowledge that the app is provided as is.

Downloading of maps, games, music and videos and uploading of images and videos may involve transferring large amounts of data. Your service provider may charge for the data transmission. The availability of particular products, services and features may vary by region. Please check with your local dealer for further details and availability of language options.

Certain features, functionality and product specifications may be network dependent and subject to additional terms, conditions, and charges.

All specifications, features and other product information provided are subject to change without notice.

HMD Global Privacy Policy, available at <http://www.hmd.com/privacy>, applies to your use of the device.

TM and © 2024 HMD Global. All rights reserved. HMD Global Oy is a licensee of the Nokia brand for phones & tablets. Nokia is a registered trademark of Nokia Corporation.

The Bluetooth word mark and logos are owned by the Bluetooth SIG, Inc. and any use of such marks by HMD Global is under license.

This product includes open source software. For applicable copyright and other notices, permissions, and acknowledgements, select `*#6774#` on the home screen.