

**NOKIA**

# **Nokia 235 4G**

## **User Guide**

# Table of Contents

<b>1</b>	<b>About this user guide</b>	<b>4</b>
<b>2</b>	<b>Get started</b>	<b>5</b>
	Keys and parts . . . . .	5
	Set up and switch on your phone . . . . .	6
	☎️ 📞 📧 📧 . . . . .	8
	Keypad . . . . .	9
<b>3</b>	<b>☎️, 📞 📧 📧</b>	<b>10</b>
	Calls . . . . .	10
	Contacts . . . . .	10
	Send messages . . . . .	11
<b>4</b>	<b>🔔 📞 📧 📧 📧 📧</b>	<b>12</b>
	Change tones . . . . .	12
	Change the look of your home screen . . . . .	12
	Profiles . . . . .	12
<b>5</b>	<b>Camera</b>	<b>13</b>
	Photos and videos . . . . .	13
<b>6</b>	<b>🕒, 📧 📧 📧 📧 📧 📧</b>	<b>14</b>
	Set the time and date manually . . . . .	14
	Alarm clock . . . . .	14
	Calendar . . . . .	14
	Calculator . . . . .	14
<b>7</b>	<b>Empty your phone</b>	<b>15</b>
	Restore factory settings . . . . .	15

<b>8 Product and safety information</b>	<b>16</b>
<b>Product information</b>	<b>16</b>
<b>Product name</b>	<b>18</b>
<b>Product model</b>	<b>18</b>
<b>Product version</b>	<b>19</b>
<b>Product features</b>	<b>20</b>
<b>Battery and charger information</b>	<b>20</b>
<b>Battery</b>	<b>21</b>
<b>Charger</b>	<b>21</b>
<b>Charging</b>	<b>22</b>
<b>Protect your device from harmful content</b>	<b>22</b>
<b>Content restrictions</b>	<b>23</b>
<b>Content restrictions and parental controls</b>	<b>23</b>
<b>Specific Absorption Rate (SAR)</b>	<b>23</b>
<b>Product safety and other notices</b>	<b>24</b>
<b>Copyrights and other notices</b>	<b>24</b>

# 1 About this user guide



**Important:** For important information on the safe use of your device and battery, read “Product and safety information” before you take the device into use. To find out how to get started with your new device, read the user guide.

## 2 Get started

### KEYS AND PARTS

#### Your phone

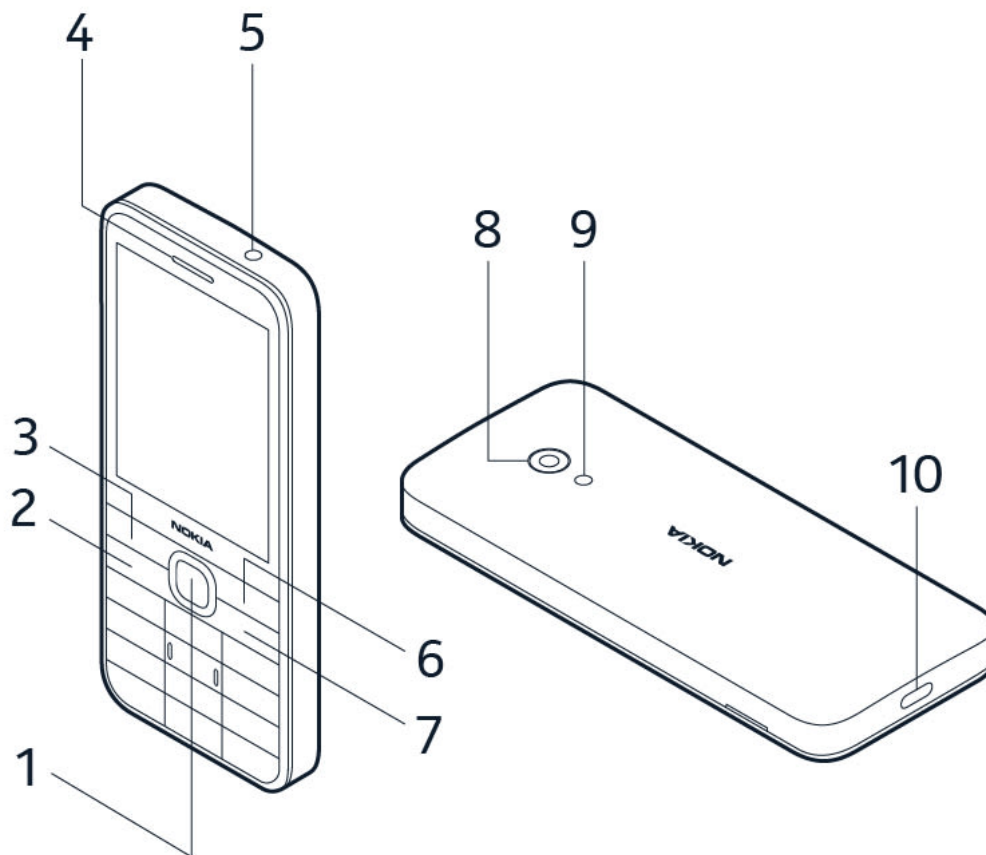

This user guide applies to the following models: TA-1612, TA-1614, TA-1622, TA-1616.

- |                         |                        |
|-------------------------|------------------------|
| 1. Scroll key           | 6. Right selection key |
| 2. Call key             | 7. Power/End key       |
| 3. Left selection key   | 8. Camera              |
| 4. Earpiece/Loudspeaker | 9. Flashlight          |
| 5. Headset connector    | 10. USB connector      |

Some of the accessories mentioned in this user guide, such as charger, headset, or data cable, may be sold separately.



**Note:** You can set the phone to ask for a security code. Select [Menu](#) > [Settings](#) > [Security](#) > [Keyguard](#) > [Security code](#), and enter a code. Note, however, that you need to remember the code, as HMD Global is not able to open or bypass it.



## Open the back cover

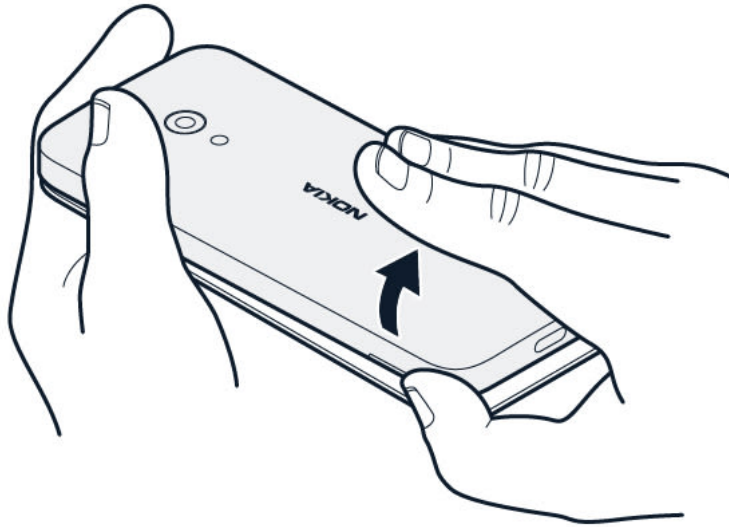

1. Put your fingernail in the small slot at the side of the phone, lift and remove the cover.
2. If the battery is in the phone, lift it out.

## Insert the SIM cards

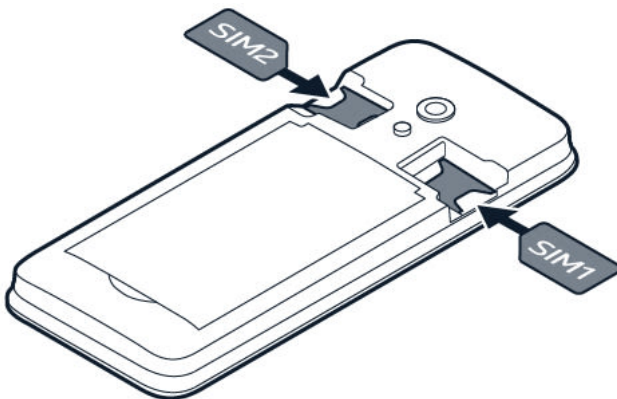

1. Slide the SIM card in the SIM card slot.
2. If you have a dual-SIM phone, slide the second SIM in the SIM2 slot.

Both SIM cards are available at the same time when the device is not being used, but while one SIM card is active, for example, making a call, the other may be unavailable.



**Tip:** To find out if your phone can use 2 SIM cards, see the label on the sales box. If there are 2 IMEI codes on the label, you have a dual-SIM phone.

## Insert the memory card

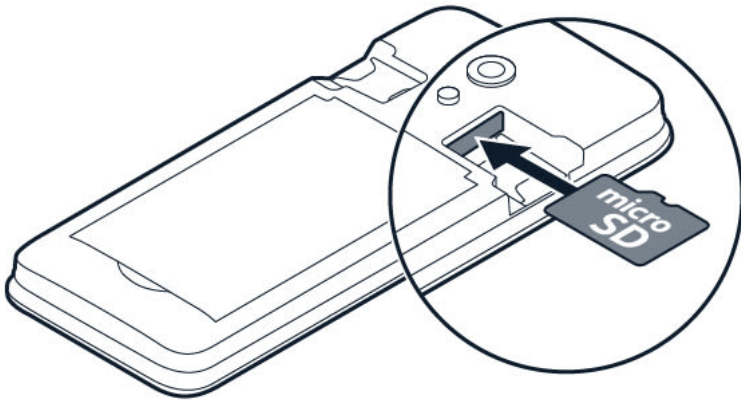

1. Slide the memory card in the memory card slot.
2. Put back the battery.
3. Put back the back cover.

Use only compatible memory cards approved for use with this device. Incompatible cards may damage the card and the device and corrupt data stored on the card.



**Tip:** Use a fast, up to 32 GB microSD memory card from a well-known manufacturer.

MicroSD

MicroSD

MicroSD

MicroSD

MicroSD

1. MicroSD
2. MicroSD

MicroSD



MicroSD

## KEYPAD

### Use the phone keys

- To see the apps and features of your phone, on the home screen, select **Menu**.
- To go to an app or feature, press the scroll key up, down, left, or right. To open the app or feature, press the scroll key.
- If you have selected the zoomed menu view, press the scroll key up or down to go to an app or feature. To open the app or feature, press the scroll key.

### Lock the keypad

To lock the keys, select **Lock keypad**. To unlock the keys, select **Unlock**, and press \*.

### Write with the keypad

Press a key repeatedly until the letter is shown.

To type in a space press **0**.

To type in a special character or punctuation mark, press the asterisk key, or if you are using predictive text, press and hold the # key.

To switch between character cases, press **#** repeatedly.

To type in a number, press and hold a number key.

### 3 𐀀, 𐀀𐀀𐀀𐀀𐀀𐀀 𐀀𐀀 𐀀𐀀𐀀𐀀𐀀

## CALLS

𐀀𐀀 𐀀𐀀

𐀀𐀀𐀀𐀀𐀀 𐀀𐀀𐀀𐀀 𐀀𐀀𐀀 𐀀𐀀 𐀀𐀀𐀀 𐀀𐀀 𐀀𐀀𐀀𐀀 𐀀𐀀 𐀀𐀀𐀀𐀀𐀀!

1. 𐀀𐀀 𐀀𐀀𐀀𐀀 𐀀𐀀𐀀 𐀀𐀀𐀀𐀀 𐀀𐀀𐀀𐀀𐀀𐀀𐀀𐀀𐀀 𐀀𐀀𐀀 𐀀𐀀𐀀 𐀀𐀀𐀀𐀀𐀀 + 𐀀𐀀𐀀𐀀 𐀀𐀀𐀀 𐀀𐀀𐀀 𐀀𐀀𐀀 \* 𐀀𐀀'𐀀𐀀𐀀 𐀀𐀀𐀀𐀀!
2. 𐀀𐀀𐀀𐀀𐀀! 𐀀𐀀𐀀𐀀𐀀𐀀𐀀 𐀀𐀀 𐀀𐀀 𐀀𐀀 𐀀𐀀 𐀀𐀀𐀀𐀀𐀀𐀀 𐀀𐀀𐀀 𐀀𐀀 𐀀𐀀 𐀀𐀀𐀀𐀀𐀀
3. 𐀀𐀀 𐀀𐀀𐀀 𐀀𐀀𐀀, 𐀀𐀀𐀀 𐀀𐀀𐀀𐀀𐀀

𐀀𐀀𐀀𐀀 𐀀𐀀𐀀𐀀 𐀀𐀀𐀀𐀀𐀀 𐀀𐀀𐀀

𐀀𐀀𐀀𐀀𐀀!

## CONTACTS

### Add a contact

1. Select **Menu** > **Contacts** > **≡** > **Add new contact**.
2. Select where to save the contact.
3. Write the name, and type in the number.
4. Select **≡** > **Save contact**.

### Save a contact from the call logs

1. Select **Menu** > **Call logs**, and select the call type.
2. Scroll to the number you want to save and select **≡** > **Add to contacts** > **New contact**.
3. Select where to save the contact.
4. Add the contact details and select **≡** > **Save contact**.

### Call a contact

You can call a contact directly from the contacts list.

Select **Menu** > **Contacts**, scroll to the contact you want to call, and press the call key.

## SEND MESSAGES

### Write and send messages

1. Select **Menu** > **Messages** > **+ New message**.
2. Type in a phone number, or press  and select a recipient from your contacts list.
3. Write your message.
4. To insert symbols to the message, press \*.
5. Select **Send**. If asked, select which SIM to use.

## 4 音調を変更する

### CHANGE TONES

#### Set new tones

1. Select **Menu** > **Settings** > **Profiles**, scroll to a profile and select **≡** > **Settings** > **Ring settings**.
2. Select which tone you want to change.
3. Scroll to the tone that you want and select **Select**.

### CHANGE THE LOOK OF YOUR HOME SCREEN

#### Choose a new wallpaper

You can change the background of your home screen.

1. Select **Menu** > **Settings** > **Personalisation** > **Lock screen background** > **Wallpapers**.
2. Select the wallpaper you want.

### PROFILES

#### Set a profile

There are several profiles that you can use in different situations. There is, for example, a silent profile for when you cannot have sounds on, and an outdoor profile with loud tones.

1. Select **Menu** > **Settings** > **Profiles**.
2. To adjust a profile, scroll to it, and select **≡** > **Settings**. Change the settings you want.
3. To set on a profile, scroll to it, and select **Select**.

## 5 Camera



### PHOTOS AND VIDEOS

#### Take a photo

1. Select **Menu** > **Camera**.
2. To zoom in or out, scroll up or down.
3. To take a photo, press the scroll key.

To see the photo you just took, on the home screen, select **Menu** > **Gallery**.

#### Record a video

1. To switch the video camera on, select **Menu** > **Camera** and scroll to .
2. To start recording, press the scroll key.
3. To stop recording, select .

To see the video you just recorded, on the home screen, select **Menu** > **Videos**.

## 6 時間, 日付, 時刻表, アラーム, カレンダー, カルキュレーター

### SET THE TIME AND DATE MANUALLY

#### Change the time and date

1. Select **Menu** > **Settings** > **Time & language** > **Date and time**.
2. Select **Auto-update** > **Change**.
3. Select **Time zone** and enter the time zone.
4. Select **Time** and enter the time.
5. Select **Date** and enter the date.
6. Select **Save**.

### ALARM CLOCK

#### Set an alarm

1. Select **Menu** > **Alarm**.
2. Select **New alarm** and enter the alarm time and other details.

### CALENDAR

#### Add a calendar event

1. Select **Menu** > **Extras** > **Calendar**.
2. Scroll to a date, and select **≡** > **Add new event**.
3. Enter the event name and other details, and select **Save**.

### CALCULATOR

#### Use the calculator

1. Select **Menu** > **Extras** > **Calculator**.
2. Enter the first factor of your calculation, use the scroll key to select the operation, and enter the second factor.
3. Press the scroll key to get the result of the calculation.

Select **☒** to empty the number fields.













temperatures and lose enough power to switch off the phone within minutes. When you are outdoors in cold temperatures, keep your phone warm.

Obey local regulations. Recycle when possible. Do not dispose as household waste.

Do not expose the battery to extremely low air pressure or leave it to extremely high temperature, for example dispose it in a fire, as that may cause the battery to explode or leak flammable liquid or gas.

Do not dismantle, cut, crush, bend, puncture, or otherwise damage the battery in any way. If a battery leaks, do not let liquid touch skin or eyes. If this happens, immediately flush the affected areas with water, or seek medical help. Do not modify, attempt to insert foreign objects into the battery, or immerse or expose it to water or other liquids. Batteries may explode if damaged.

Use the battery and charger for their intended purposes only. Improper use, or use of unapproved or incompatible batteries or chargers may present a risk of fire, explosion, or other hazard, and may invalidate any approval or warranty. If you believe the battery or charger is damaged, take it to a service centre or your phone dealer before continuing to use it. Never use a damaged battery or charger. Only use the charger indoors. Do not charge your device during a lightning storm. When charger is not included in the sales pack, charge your device using the data cable (included) and a USB power adaptor (may be sold separately). You can charge your device with third-party cables and power adaptors that are compliant with USB 2.0 or later and with applicable country regulations and international and regional safety standards. Other adaptors may not meet applicable safety standards, and charging with such adaptors could pose a risk of property loss or personal injury.

To unplug a charger or an accessory, hold and pull the plug, not the cord.

Additionally, the following applies if your device has a removable battery:

- Always switch the device off and unplug the charger before removing any covers or the battery.
- Accidental short-circuiting can happen when a metallic object touches the metal strips on the battery. This may damage the battery or the other object.

## 安全警告

在低温下，手机可能会因电量耗尽而在几分钟内关机。如果您在低温环境下使用手机，请保持手机温暖。

## 遵守当地法规

请仅将电池和充电器用于其 intended 用途。不当使用，或使用未经批准或不兼容的电池或充电器可能会带来火灾、爆炸或其他危险，并可能使任何批准或保修无效。如果您认为电池或充电器已损坏，请在继续使用之前将其带到服务中心或手机经销商处。切勿使用损坏的电池或充电器。只能在室内使用充电器。不要在雷暴期间为您的设备充电。如果充电器不在销售包装中，请使用数据电缆（随附）和 USB 电源适配器（可能单独出售）。您可以使用符合 USB 2.0 或更高版本以及适用国家法规和国际和区域安全标准的第三方电缆和电源适配器。其他适配器可能不符合适用的安全标准，使用此类适配器可能会带来财产损失或人身伤害的风险。







HMD Global does not make any representations, provide a warranty, or take any responsibility for the functionality, content, or end-user support of third-party apps provided with your device. By using an app, you acknowledge that the app is provided as is.

Downloading of maps, games, music and videos and uploading of images and videos may involve transferring large amounts of data. Your service provider may charge for the data transmission. The availability of particular products, services and features may vary by region. Please check with your local dealer for further details and availability of language options.

Certain features, functionality and product specifications may be network dependent and subject to additional terms, conditions, and charges.

All specifications, features and other product information provided are subject to change without notice.

HMD Global Privacy Policy, available at <http://www.hmd.com/privacy>, applies to your use of the device.

TM and © 2024 HMD Global. All rights reserved. HMD Global Oy is a licensee of the Nokia brand for phones & tablets. Nokia is a registered trademark of Nokia Corporation.

The Bluetooth word mark and logos are owned by the Bluetooth SIG, Inc. and any use of such marks by HMD Global is under license.

This product includes open source software. For applicable copyright and other notices, permissions, and acknowledgements, select `*#6774#` on the home screen.