

NOKIA

Nokia 2660 Flip

User Guide

9 Product and safety information	19
Product information	19
Product features	21
Product specifications	22
Product safety	22
Product safety information	23
Battery and charger information	23
Battery	24
Charger	25
Charging	25
Protect your device from harmful content	25
Content protection	26
Content protection and parental controls	26
Content protection (SAR)	26
Content protection and parental controls	27
Copyrights and other notices	27
Online safety	28

1 About this user guide



Important: For important information on the safe use of your device and battery, read “Product and safety information” before you take the device into use. To find out how to get started with your new device, read the user guide.

2 Get started

KEYS AND PARTS

Your phone

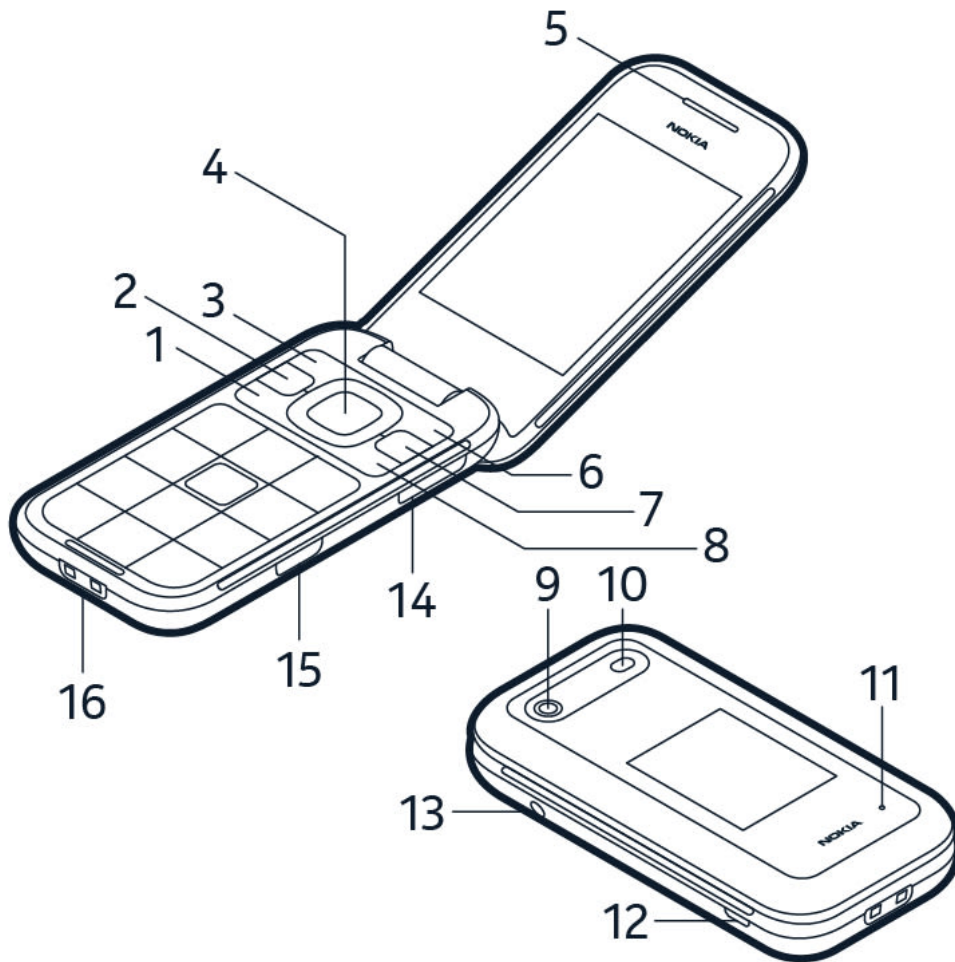

This user guide applies to the following models: TA-1469, TA-1474, TA-1480, TA-1478, TA-1491.

- | | |
|------------------------|-------------------------------|
| 1. Call key | 9. Camera |
| 2. Shortcut key | 10. Flash |
| 3. Left selection key | 11. Microphone |
| 4. Scroll key | 12. USB connector |
| 5. Earpiece | 13. Headset connector |
| 6. Right selection key | 14. Volume keys |
| 7. Back key | 15. SOS call key |
| 8. Power/End key | 16. Charging cradle connector |

Open the back cover

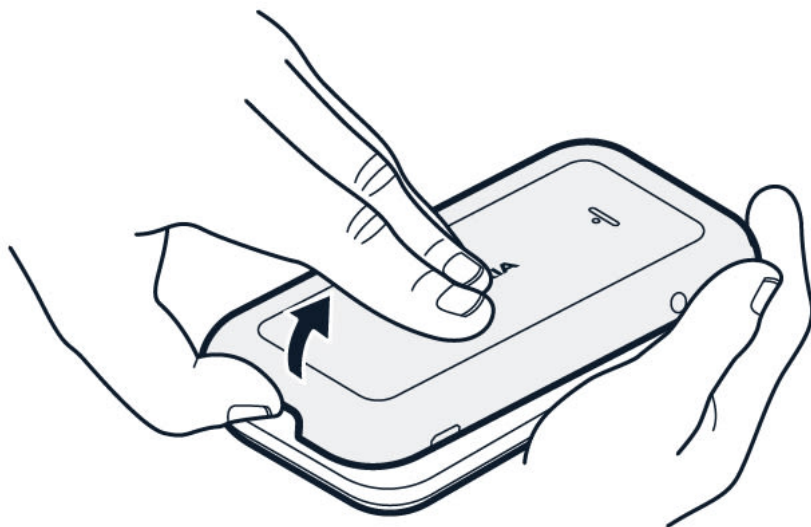

1. Put your fingernail in the small slot at the top of the phone, lift and remove the cover.
2. If the battery is in the phone, lift it out.

Insert the SIM card

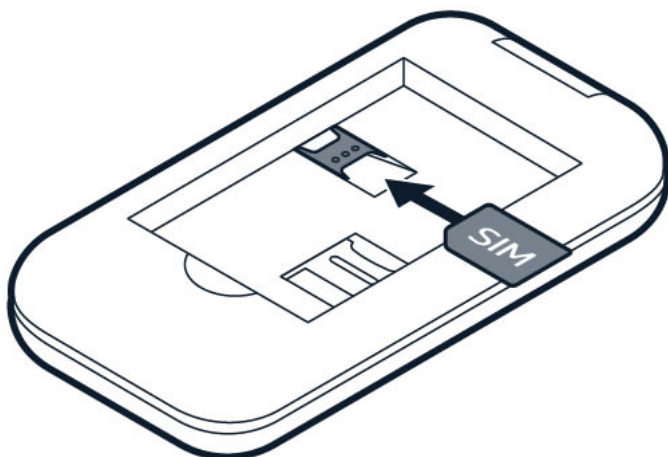

Slide the SIM card in the SIM card slot with the contact area face down.

Insert the second SIM

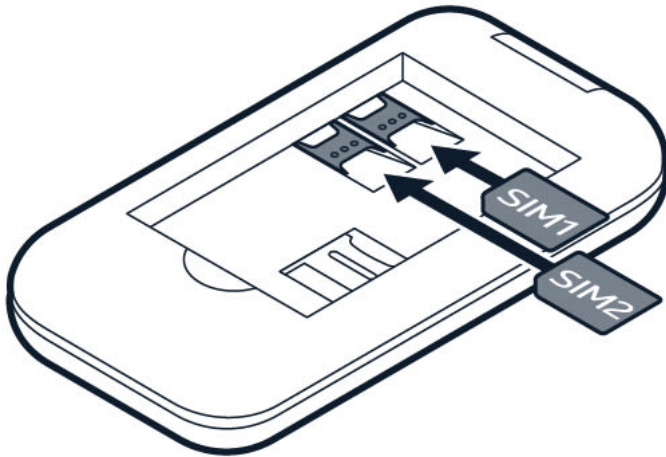

If you have a dual-SIM phone, slide your SIM card in the SIM1 slot and the second SIM in the SIM2 slot. Both SIM cards are available at the same time when the device is not being used, but while one SIM card is active, for example, making a call, the other may be unavailable.



Tip: To find out if your phone can use 2 SIM cards, see the label on the sales box. If there are 2 IMEI codes on the label, you have a dual-SIM phone.

Insert the memory card

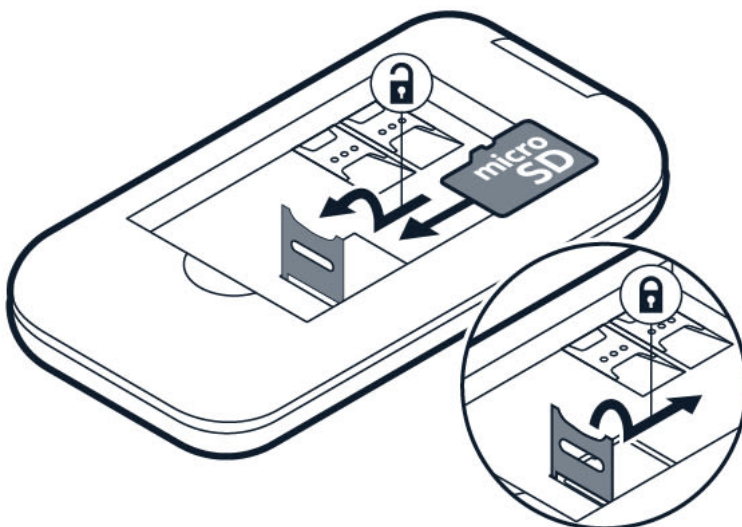

1. Slide the memory card holder down and open it up.
2. Place the memory card in the slot.
3. Close down the holder and slide it up to lock it in place.
4. Put back the battery.
5. Put back the back cover.



Tip: Use a fast, up to 32 GB microSD memory card from a well-known manufacturer.

MicroSD card

MicroSD card

MicroSD card

MicroSD card

MicroSD card

1. MicroSD card
2. MicroSD card

MicroSD card



MicroSD card

KEYPAD

Use the phone keys

- To see the apps and features of your phone, on the home screen, select **Menu**.
- To go to an app or feature, press the scroll key up, down, left, or right. To open the app or feature, press the scroll key.
- To go back to the home screen, press the end key
- To change the volume of your phone during a call or when listening to the radio, press the volume keys.

Lock the keypad

To lock the keys, close the fold. To unlock the keys, press the scroll key and select **Unlock** > *****.

Write with the keypad

Press a key repeatedly until the letter is shown.

To type in a space press the 0 key.

To type in a special character or punctuation mark, press the asterisk key.

To switch between character cases, press # repeatedly.

To type in a number, press and hold a number key.

To remove a character, select .

3 𐀀, 𐀀𐀀𐀀𐀀𐀀𐀀 𐀀𐀀 𐀀𐀀𐀀𐀀𐀀

CALLS

𐀀𐀀 𐀀𐀀

𐀀𐀀𐀀𐀀𐀀 𐀀𐀀𐀀𐀀 𐀀𐀀𐀀𐀀 𐀀𐀀 𐀀𐀀𐀀𐀀 𐀀𐀀 𐀀𐀀𐀀𐀀𐀀 𐀀𐀀 𐀀𐀀𐀀𐀀𐀀

1. 𐀀𐀀 𐀀𐀀𐀀𐀀 𐀀𐀀𐀀 𐀀𐀀𐀀𐀀 𐀀𐀀𐀀𐀀𐀀𐀀𐀀𐀀𐀀 𐀀𐀀𐀀 𐀀𐀀𐀀 𐀀𐀀𐀀𐀀𐀀 + 𐀀𐀀𐀀𐀀 𐀀𐀀𐀀 𐀀𐀀𐀀 𐀀𐀀𐀀 * 𐀀𐀀'𐀀𐀀𐀀 𐀀𐀀𐀀𐀀𐀀
2. 𐀀𐀀𐀀𐀀𐀀 𐀀𐀀𐀀𐀀𐀀𐀀𐀀 𐀀𐀀 𐀀𐀀 𐀀𐀀 𐀀𐀀 𐀀𐀀𐀀𐀀𐀀𐀀 𐀀𐀀𐀀 𐀀𐀀 𐀀𐀀 𐀀𐀀𐀀𐀀𐀀
3. 𐀀𐀀 𐀀𐀀 𐀀𐀀𐀀, 𐀀𐀀 𐀀𐀀𐀀𐀀

𐀀𐀀𐀀𐀀 𐀀𐀀𐀀𐀀 𐀀𐀀𐀀𐀀𐀀 𐀀𐀀

𐀀𐀀𐀀𐀀𐀀

CONTACTS

Add a contact

1. Select **Menu** > **Contacts** > **≡** > **Add new contact**.
2. Select where to save the contact.
3. Write the name, and type in the number.
4. Select **Save**.

Save a contact from call log

1. Select **Menu** > **Call history**, and scroll left to **Missed calls**, **Dialed calls**, **Received calls**, or **Rejected calls**, depending on from where you want to save the contact.
2. Scroll to the number you want to save, select **≡** > **Add to Contacts**, and select whether this is a new or an existing contact.
3. Select where you want to save the contact.
4. Add the contact's name, check that the phone number is correct, and select **Save**.

Call a contact

You can call a contact directly from the contacts list.

1. Select **Menu** > **Contacts**.
2. Scroll to the contact you want to call.
3. Press the call key.

SEND MESSAGES

Write and send messages

1. Select **Menu** > **Messaging** > **+ New message**.
2. Type in a phone number, or select  > **Contacts**, and select a recipient from your contacts list.
3. Scroll down and write your message.
4. Select **Send**. If asked, select which SIM to use.

4 音調を変更する

CHANGE TONES

Set new tones

1. Select **Menu** > **Settings** > **Personalisation** > **Sounds**.
2. Scroll to the tone that you want and select **OK**.

CHANGE THE LOOK OF YOUR HOME SCREEN

Choose a new wallpaper

You can change the background of your home screen.

1. Select **Menu** > **Settings** > **Personalisation** > **Lock screen background** > **Wallpapers**.
2. Select the wallpaper you want.

ACCESSIBILITY

Change the menu view

To select how the apps menu is shown on the screen, select **Menu** > **Settings** > **System** > **Main menu view** and select **3x3** to see 9 apps in the menu at the same time or **1x1** to see 1 app at a time. If you select **1x1**, scroll up or down to move between the apps.

Add your ICE details

To be able to make SOS calls, you need to add your ICE (In Case of Emergency) details.

1. Add your personal details: select **Menu** > **Settings** > **Device** > **ICE information** > **Basic info** and **Important Information**.
2. Select the contacts to whom the SOS call is made: select **Menu** > **Settings** > **Device** > **SOS** > **ICE contacts**, and select the ICE contacts from your contacts list. Note that you cannot use official emergency call numbers as your ICE contacts.
3. Before you can make SOS calls, you need to enable them. Select **Menu** > **Settings** > **Device** > **SOS** > **SOS settings**, and switch **SOS call** on.

Make an SOS call

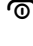
Press and hold the SOS call key for a few seconds. The phone calls your first ICE contact. If the contact doesn't answer in 25 seconds, the phone calls the next contact, and keeps calling your contacts until one of them answers the call, or you press . Note: When the SOS call is answered, the phone goes to handsfree mode. Do not hold the phone close to your ear, as the volume may be very loud.

5 Camera



PHOTOS AND VIDEOS

Take a photo

1. Select **Menu** > **Camera**.
2. To zoom in or out, scroll up or down.
3. To take a photo, press the scroll key.

To see the photo you just took, on the home screen, select **Menu** > **Gallery**.

Record a video

1. To switch the video camera on, select **Menu** > **Camera** and scroll to .
2. To start recording, press the scroll key.
3. To stop recording, select .

To see the video you just recorded, on the home screen, select **Menu** > **Video**.

6 Bluetooth

BLUETOOTH® CONNECTIONS

Switch on Bluetooth

1. Select **Menu** > **Settings** > **Connectivity** > **Bluetooth**.
2. Switch **Bluetooth** on.
3. Select **Devices found** > **Add new device**.
4. Scroll to the found device and select **Pair**. If asked, confirm the passcode.

7 時間, 時間設定, 時間設定

ALARM CLOCK

Set an alarm

1. Select **Menu** > **Alarm clock**.
2. Select **+New alarm**.
3. Use the number keys to set the time.
4. Set the details for the alarm, if needed.
5. Select **Save**.

CALENDAR

Add a calendar event

1. Select **Menu** > **Calendar**.
2. Scroll to a date, and select **Options** > **Add new schedule**.
3. Enter the event details and select **Save**.

CALCULATOR

Use the calculator

1. Select **Menu** > **Calculator**.
2. Enter the first factor of your calculation, use the scroll key to select the operation, and enter the second factor.
3. Press the scroll key to get the result of the calculation.

Select  to empty the number fields.

9 Product and safety information

Product information

This product is designed to be used in a safe and secure manner. It is not intended for use in hazardous environments or for any other purpose not intended by the manufacturer. For more information, please refer to the user manual.

Product safety information



Do not use the mobile phone while driving or operating machinery. Using the mobile phone while driving can distract your attention and increase the risk of an accident. It is recommended to use hands-free devices or pull over to use the phone. For more information, please refer to the user manual.

Product safety information



Do not use the mobile phone while driving or operating machinery. Using the mobile phone while driving can distract your attention and increase the risk of an accident. It is recommended to use hands-free devices or pull over to use the phone. For more information, please refer to the user manual.

Product safety information



Do not use the mobile phone while driving or operating machinery. Using the mobile phone while driving can distract your attention and increase the risk of an accident. It is recommended to use hands-free devices or pull over to use the phone. For more information, please refer to the user manual.

பொருள் பிடிக்கிறது



பொருள் பிடிக்கிறது என்பது பொருள் பிடிக்கிறது என்பதைக் குறிக்கிறது. இது பொருள் பிடிக்கிறது என்பதைக் குறிக்கிறது.

பொருள் பிடிக்கிறது, பொருள் பிடிக்கிறது என்பதைக் குறிக்கிறது.



இது பொருள் பிடிக்கிறது என்பதைக் குறிக்கிறது. HMD Global Oy பொருள் பிடிக்கிறது, பொருள் பிடிக்கிறது என்பதைக் குறிக்கிறது. பொருள் பிடிக்கிறது என்பதைக் குறிக்கிறது.

பொருள் பிடிக்கிறது என்பதைக் குறிக்கிறது.



பொருள் பிடிக்கிறது என்பதைக் குறிக்கிறது. பொருள் பிடிக்கிறது என்பதைக் குறிக்கிறது.

பொருள் பிடிக்கிறது என்பதைக் குறிக்கிறது.



මෙහිදී සඳහන් කර ඇති SAR-වටිනාකම සඳහා වන සීමාවන් සහිතව භාවිතය කරන්න. මෙහිදී සඳහන් කර ඇති SAR-වටිනාකම සඳහා වන සීමාවන් සහිතව භාවිතය කරන්න. මෙහිදී සඳහන් කර ඇති SAR-වටිනාකම සඳහා වන සීමාවන් සහිතව භාවිතය කරන්න. මෙහිදී සඳහන් කර ඇති SAR-වටිනාකම සඳහා වන සීමාවන් සහිතව භාවිතය කරන්න.

මෙහිදී සඳහන් කර ඇති SAR-වටිනාකම සඳහා වන සීමාවන් සහිතව භාවිතය කරන්න. මෙහිදී සඳහන් කර ඇති SAR-වටිනාකම සඳහා වන සීමාවන් සහිතව භාවිතය කරන්න. මෙහිදී සඳහන් කර ඇති SAR-වටිනාකම සඳහා වන සීමාවන් සහිතව භාවිතය කරන්න.

මෙහිදී සඳහන් කර ඇති SAR-වටිනාකම සඳහා වන සීමාවන් සහිතව භාවිතය කරන්න. මෙහිදී සඳහන් කර ඇති SAR-වටිනාකම සඳහා වන සීමාවන් සහිතව භාවිතය කරන්න. මෙහිදී සඳහන් කර ඇති SAR-වටිනාකම සඳහා වන සීමාවන් සහිතව භාවිතය කරන්න.

මෙහිදී සඳහන් කර ඇති SAR-වටිනාකම සඳහා වන සීමාවන් සහිතව භාවිතය කරන්න. මෙහිදී සඳහන් කර ඇති SAR-වටිනාකම සඳහා වන සීමාවන් සහිතව භාවිතය කරන්න. මෙහිදී සඳහන් කර ඇති SAR-වටිනාකම සඳහා වන සීමාවන් සහිතව භාවිතය කරන්න. මෙහිදී සඳහන් කර ඇති SAR-වටිනාකම සඳහා වන සීමාවන් සහිතව භාවිතය කරන්න.

මෙහිදී සඳහන් කර ඇති SAR-වටිනාකම සඳහා වන සීමාවන් සහිතව භාවිතය කරන්න.

මෙහිදී සඳහන් කර ඇති SAR-වටිනාකම සඳහා වන සීමාවන් සහිතව භාවිතය කරන්න. මෙහිදී සඳහන් කර ඇති SAR-වටිනාකම සඳහා වන සීමාවන් සහිතව භාවිතය කරන්න. මෙහිදී සඳහන් කර ඇති SAR-වටිනාකම සඳහා වන සීමාවන් සහිතව භාවිතය කරන්න.

COPYRIGHTS AND OTHER NOTICES

Copyrights

The availability of products, features, apps and services may vary by region. For more info, contact your dealer or your service provider. This device may contain commodities, technology or software subject to export laws and regulations from the US and other countries. Diversion contrary to law is prohibited.

The contents of this document are provided "as is". Except as required by applicable law, no warranties of any kind, either express or implied, including, but not limited to, the implied warranties of merchantability and fitness for a particular purpose, are made in relation to the accuracy, reliability or contents of this document. HMD Global reserves the right to revise this document or withdraw it at any time without prior notice.

To the maximum extent permitted by applicable law, under no circumstances shall HMD Global or any of its licensors be responsible for any loss of data or income or any special, incidental, consequential or indirect damages howsoever caused.

Reproduction, transfer or distribution of part or all of the contents in this document in any form without the prior written permission of HMD Global is prohibited. HMD Global operates a policy of continuous development. HMD Global reserves the right to make changes and improvements to any of the products described in this document without prior notice.

HMD Global does not make any representations, provide a warranty, or take any responsibility for the functionality, content, or end-user support of third-party apps provided with your device. By using an app, you acknowledge that the app is provided as is.

Downloading of maps, games, music and videos and uploading of images and videos may involve transferring large amounts of data. Your service provider may charge for the data transmission. The availability of particular products, services and features may vary by region. Please check with your local dealer for further details and availability of language options.

Certain features, functionality and product specifications may be network dependent and subject to additional terms, conditions, and charges.

All specifications, features and other product information provided are subject to change without notice.

HMD Global Privacy Policy, available at <http://www.hmd.com/privacy>, applies to your use of the device.

HMD Global Oy is the exclusive licensee of the Nokia brand for phones & tablets. Nokia is a registered trademark of Nokia Corporation.

The Bluetooth word mark and logos are owned by the Bluetooth SIG, Inc. and any use of such marks by HMD Global is under license.

This product includes open source software. For applicable copyright and other notices, permissions, and acknowledgements, select ***#6774#** on the home screen.

ONLINE SAFETY

Securing Multimedia Access

Your phone can access multimedia content online using the Browser application built in. Your phone can also receive multimedia content using Bluetooth™ and MMS. You can restrict access to multimedia content using the “Parental Controls” feature.

[Enable Parental controls](#)